

# **FPS** *STSseries*

## **6" 50 Hz Submersible Turbine Pumps**



**Franklin Electric**

# Submersible Turbine Pumps

## STS Series

### Performance Data:

Discharge Size: 4" BSPP  
Capacity: 20 to 90 m<sup>3</sup>/h @ BEP  
HP: 3.7 kW to 37 kW  
Head: Up to 300 m

### Applications:

- Irrigation
- Agricultural
- Industrial
- Municipal
- Commercial

### Features:

- Premium ductile iron casting for longer life and higher pressures
- Long copper bismuth discharge and motor bracket bearings for increased pump life
- Spiral cutlass rubber intermediate bearings designed for harsh environments
- 416 stainless steel pump shaft ground and polished for maximum durability
- Investment cast stainless steel impellers for maximum abrasion resistance
- Custom bearing and shaft configurations available

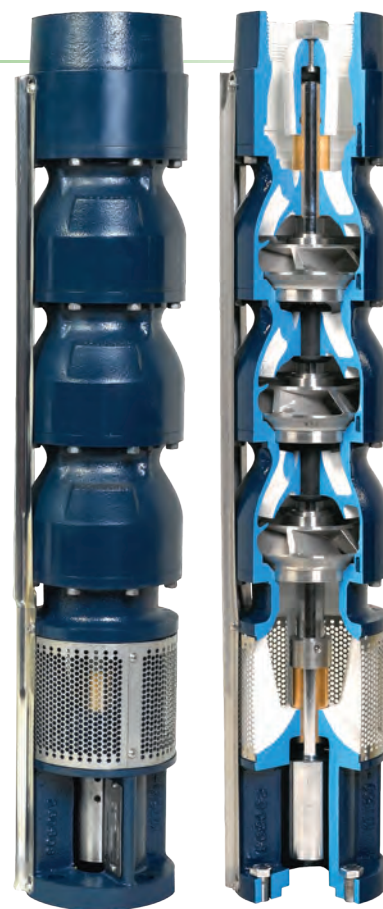

6" STS 50 Hz Family Curve

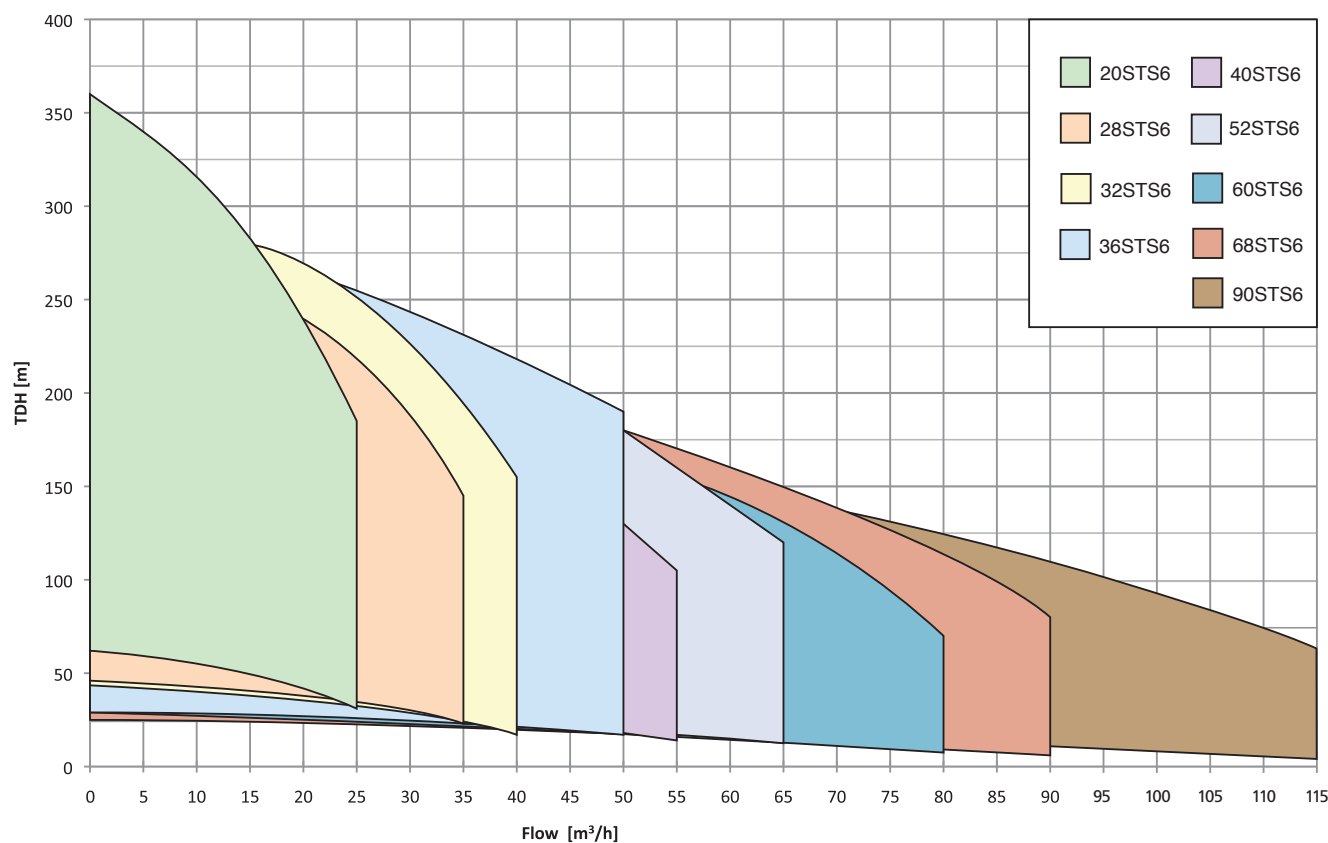

## STS Series

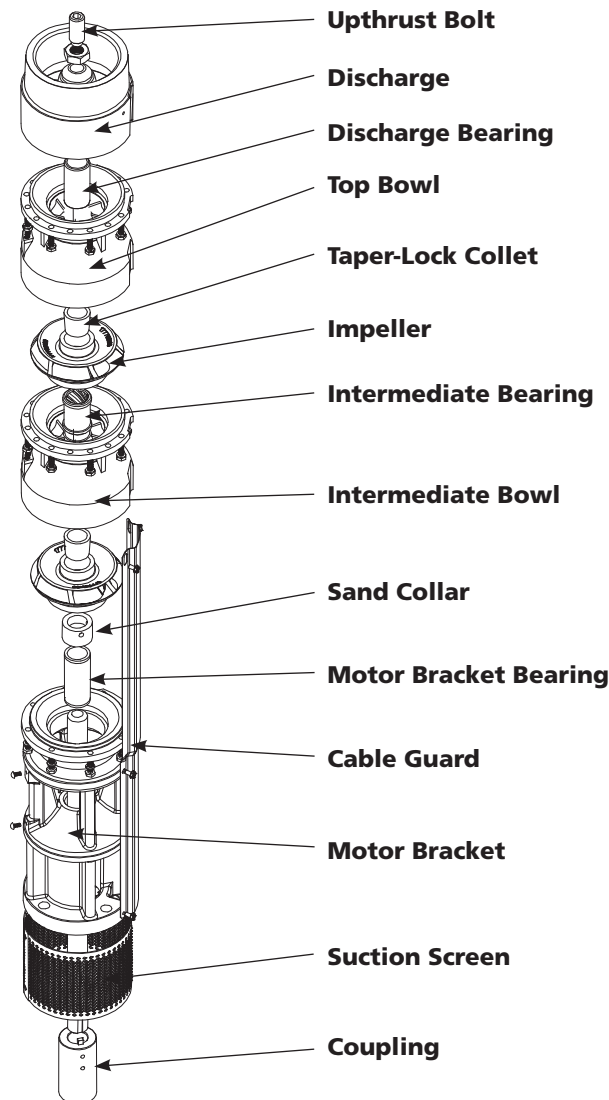

### Upthrust Bolt

Protects pump during momentary upthrust at start-up (factory set).

### Discharge

Heavy duty casting with threaded connection, supports grease packed extra long discharge bearing.

### Bolting, Fasteners, Cable Guard

Stainless steel for strength and corrosion resistance.

### Intermediate Bowl

Heavy duty casting, flanged, supports intermediate bowl bearing for reliable long life. Note: Standard bowl depicted in diagram and requires 8 bowl bolts. Nine or more stage submersible turbines require XP bowls with 14 bowl bolts.

### Impeller

Enclosed design to optimize efficiency, precision machined collet is designed to ensure locking of impeller to shaft, impeller is single plane dynamic balanced as standard.

### Pump Shaft

Minimum 100,000 psi tensile for maximum strength and corrosion resistance, ground and polished for a smooth bearing surface.

### Motor Bracket

Heavy duty casting precision machined to ensure positive motor alignment, contoured for smooth flow entrance, supports standard stainless steel sand collar.

### Suction Screen

Stainless steel design is non collapsible and corrosion resistant.

## Materials of Construction

Part Name	Common Material Name	Material Spec Number
Discharge Bracket	Ductile Iron	ASTM A536 65-45-12
Top Bowl	Ductile Iron	ASTM A536 65-45-12
Intermediate Bowl	Ductile Iron	ASTM A536 65-45-12
Bearings, Disch. & Suction	Bronze	ASTM 8584 C89835
Impeller	304 Stainless Steel	ASTM A743/A743M CF8
Pump Shaft	416 Stainless Steel	ASTM A582 S41600
Suction Bracket	Ductile Iron	ASTM A536 65-45-12
Bowl Bearing	Rubber	Rubber
Sand Collar	300 Stainless Steel	ASTM A666
Suction Screen	302 Stainless Steel	ASTM A240 S30200
Cable Guard	300 Stainless Steel	ASTM A666
Shaft Coupling	416 Stainless Steel	ASTM A582 S41600
Upthrust Bolt	300 Stainless Steel	ASTM A666
Taper Lock	416 Stainless Steel	ASTM A582 S41600
Bolting	300 Stainless Steel	ASTM A666

**Note:** Bowl bearing and shaft options available. Refer to catalog for available options.



## Franklin Electric

Franklin Electric (Aust) Pty Ltd  
106-110 Micro Circuit  
Dandenong South, Vic 3175  
Tel: +61 3 9799 5000

**Toll Free: 1300 FRANKLIN**  
**[franklinwater.com/au](http://franklinwater.com/au)**

**UNITED STATES**  
9255 Coverdale Road  
Fort Wayne, IN 46809  
Phone: +1.260.824.2900  
Fax: +1.260.824.2909