

SUBDRIVE INLINE 1100

CONSTANT PRESSURE SYSTEM

For Consistent Water Pressure

TECHNICAL INFORMATION

Flow range: Up to 135 lpm

Product power rating: 0.9 kW

Minimum incoming pressure: 0.2 – 0.3 bar (3-5 psi)

Minimum incoming flow and tanks: flooded suction without water vortexing

Maximum incremental pressure boost: 4.1 bar (60 psi)

Maximum ambient operating temp: Continuous operation – 40 °C (104 °F)

Maximum fluid operating temp: 40 °C (104 °F)

Incoming voltage: 190 – 260 vac*

Frequency: 50/60 Hz

Operating frequency range: 20 – 63 Hz

Current (maximum): 12 Amps (rms)

Pressure setting from factory: 3.4 bar (50 psi)

Pressure adjustment range: 1.7 – 5.5 bar (25 – 80 psi)

Relative humidity: 0 – 100%, condensing

Shipping weight: 22.7 kg

C Tick approved

*Drive will operate at reduced power level at 190 vac.

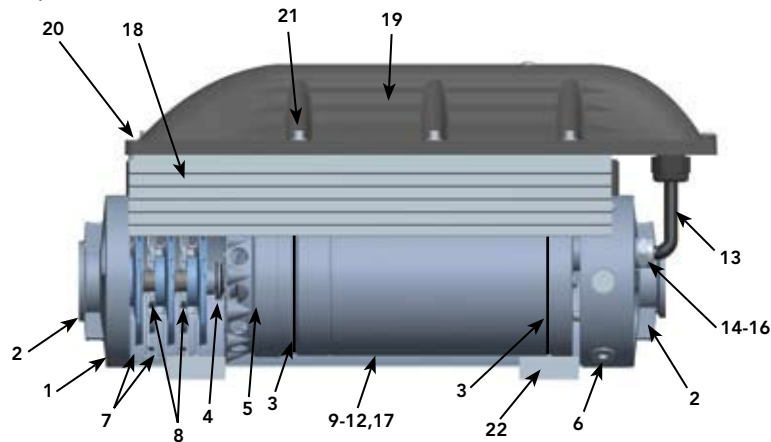

Item	Descriptor	Comment
1	Outer Shell	300 Series SS — 1.5 mm thick
2	Suction/Discharge	304 SS Casting. 1.25" NPT thread. Integrated ears to be able to hold other types of flanges if required
3	O-Rings	NBR-Nitrile Buna Rubber — Temp. rated to 40 °C (104 °F)
4	Pump Mechanical Seal	Carbide/Ceramic/Buna Rubber Seals
5	Internal Motor Seal	Silicon/Carbide/Buna Rubber Seals
6	Outer Shell Screws and Inserts	316 SS
7	Pump Hydraulics	i.e. Impellers, Diffusers, Bowls — 316 SS
8	Floating Seal Rings	PTFE
9	Motor	Dry Design
10	Motor Bearings	Ball Bearing Type — 6202 double sealed on discharge end, 6303 — suction side — double sealed All pre-greased and rated to 40 °C (104 °F)
11	Motor Shaft	304 SS
12	Motor Insulation	Class - F - IP68 rated
13	Motor Lead	14 Ga SJ00W
14	Motor Cable Gland	CuZn — Nickel plated brass
15	Motor Lead Washers	304 SS
16	Motor Lead Rubber Seal	Nitrile
17	Oil Chamber (Motor)	Filled with medical grade white oil — Marcol 82
18	Heat Sink	Die cast aluminum
19	Drive Enclosure Material	Polycarbonate (Flame Retardant, UL 94 V-0)
20	Drive Gaskets	Close Cell Foam Nitrile Rubber
21	Drive Fasteners	304 SS
22	Mounting Base	300 Series SS
N/A	Shaft Coupling	304 SS (Not Shown)

Dimensions

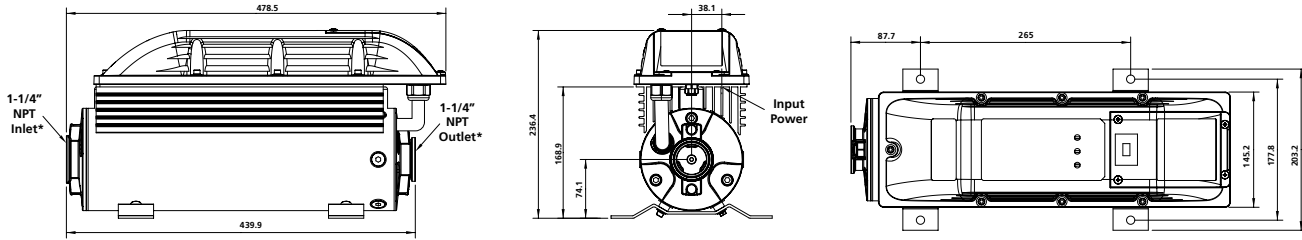

* BSPM adaptor kits supplied as standard

Performance Curve

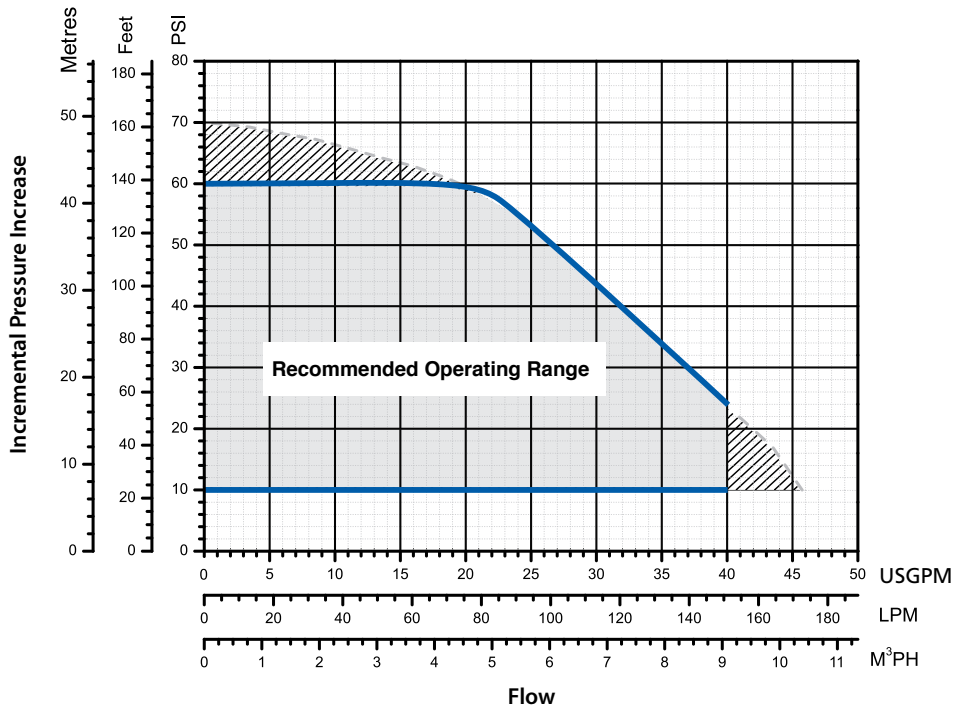

NOTE: Running outside of 'Recommended Operating Range' for short periods of time is permissible.

Ordering Information

Model Description	Order No.	Input Voltage	Input Phase
SD 1100 QuickPAK ¹	90401101-Q1	230	Single
Pressure Sensor	305707906	N/A	N/A
Pressure Tank (18 litre)	106435103	N/A	N/A
Overpressure Sensor ²	305707909	N/A	N/A

- Includes pump, motor, drive, pressure sensor, sensor cable, 18 litre tank and check valve.
- Overpressure sensor is sold as an accessory and is not required for normal operation.



Franklin Electric

Franklin Electric (Aust) Pty Ltd
 106-110 Micro Circuit
 Dandenong South, Vic 3175
 Tel: +61 3 9799 5000

Toll Free: 1300 FRANKLIN
franklin-electric.com.au

