

FPS-600FS Submersible Turbine Pump



The FS Series pumps have been engineered in all AISI 316 stainless steel for efficient and reliable pumping of liquids in marine, residential, municipal, industrial and agricultural applications.

- 40 to 780 m³/h
- 8": 100 and 130 m³/h
- 10": 180 and 200 m³/h
- 12": 260, 300 and 400 m³/h
- 14": 600 m³/h

Features:

- 100% factory tested
- Stainless Steel AISI 316 discharge and suction bracket
- Stainless Steel AISI 316 bowls
- FS Series feature: 8", 10", 12" and 14" sizes
- Stainless Steel impellers and diffusers
- Impellers locked onto shaft with keys
- Rubber & PTFE bearings
- Integrated Non Return valve on all models
- Stainless Steel 329 duplex pump shaft for increased durability
- All pumps suit Franklin Electric motors
- Flanged discharges
- Maximum running time at zero delivery is 2 minutes
- Maximum water temperature is 30°C
- Maximum solids content is 70 g/m³

Model Number Explanation

Example: 600 FS 14 - 3 A - 5 12 300

600 = Flow in m³/hr

FS = Series

14 = Pump End

3 = Stages

A = Trim

5 = 50 Hz

12 = Motor size

300 = 300 kW

FPS-600FS Submersible Turbine Pump

Part and material specifications

Item	Part name	Material
1	Delivery Bowl	316 Stainless Steel
2	Retaining Valve	316 Stainless Steel
3	Diffuser	316 Stainless Steel
4	Impeller	316 Stainless Steel
5	Journal Bearing	PTFE
6	Spacer Bushing	316 Stainless Steel
7	Wear Ring	POM
8	Shaft	329 Stainless Steel Duplex
9	Coupling	329 Stainless Steel Duplex
10	Suction Bowl	316 Stainless Steel
11	Intake Screen	316 Stainless Steel

FS Series

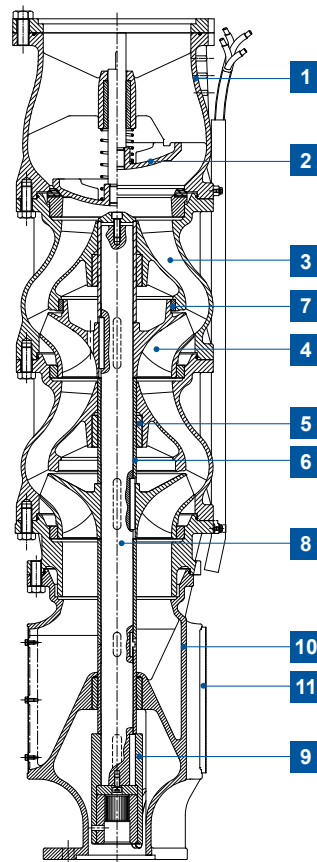

FPS-600FS Submersible Turbine Pump

Performance at 50Hz, 2 pole

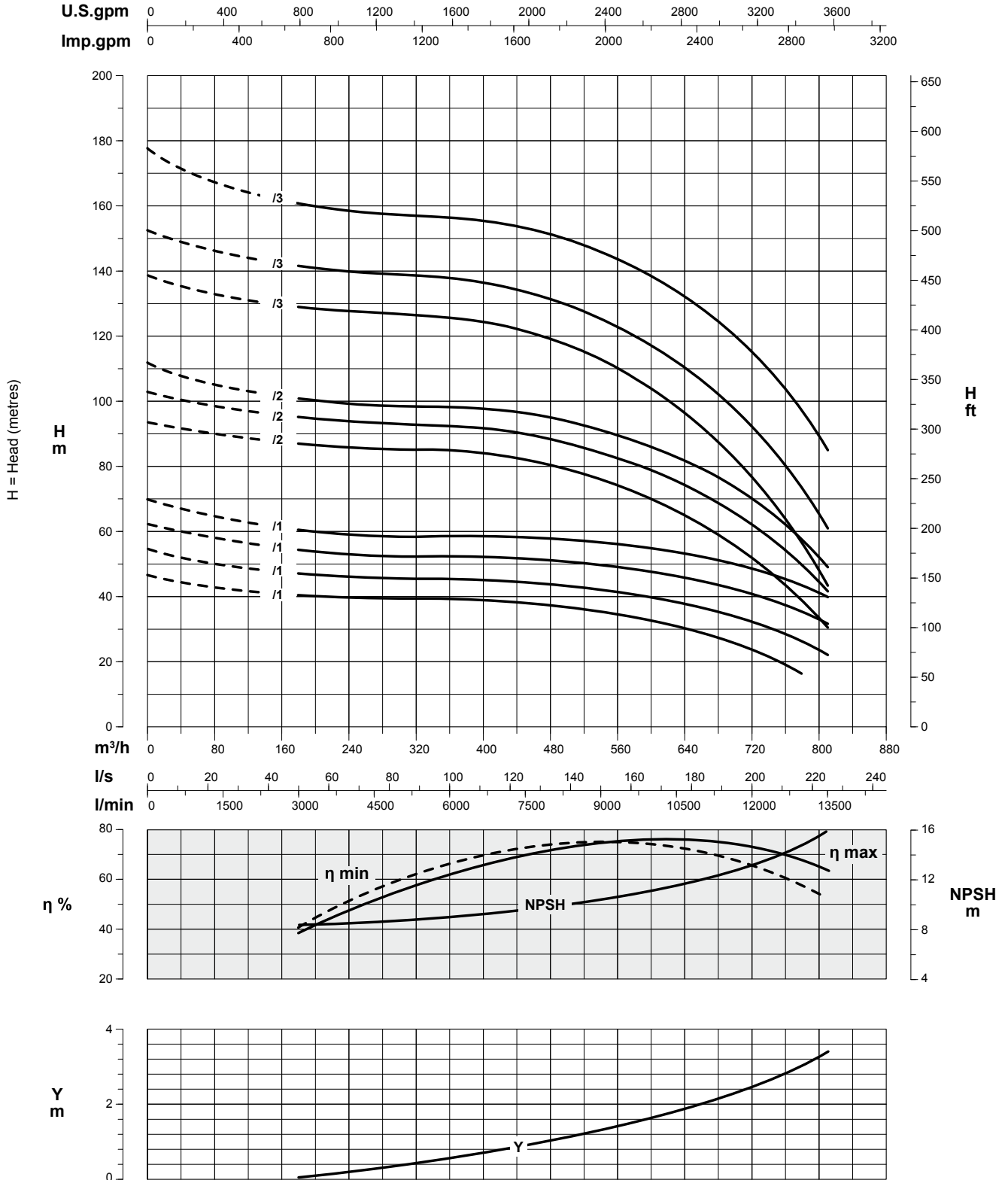

Notes:

- 1 = η Pump Efficiency, NPSH (metres), Y = Non return valve loss
- 2 = Curves based on density of 1000 kg/m³, viscosity of 1mm²/s, Temperature at 20°C

FPS-600FS

Performance and Dimensional Information

Model/Build No	kW	HP	l/min	0	3000	5000	6000	7000	8000	9000	10000	11000	12000	13000	13500
			m ³ /h	0	180	300	360	420	480	540	600	660	720	780	810
			l/s	0	50	83.3	100	116.6	133.3	150	166.6	183.3	200	216.6	225
600FS14-1D-508075	75	100	Head (m)	54	45	41	39.5	38.5	37	35	32	28	23	17.5	
600FS14-1C-508093	93	125		61	51.5	47	45.5	44	43	41.5	39.5	36	32	26	22.5
600FS14-1B-510110	110	150		68.5	59	54	52.5	51	50	48.5	47	45	41	35.5	31.5
600FS14-1A-510130	130	175		76	66	60.5	58.5	57	56.5	55.5	54	52.5	49	43.5	39.5
600FS14-2C-510150	150	200		105.5	95	88	85.5	82.5	79.5	75	69.5	61.5	51.5	39	31
600FS14-2B-510185	185	250		115	102	96	93.5	91	88	84	78.5	70.5	61	49.5	43
600FS14-2A-510185	185	250		124	108	101.5	99.5	97	94.5	90.5	85.5	78	68.5	57	50.5
600FS14-3C-512220	220	300		157.5	139.5	131.5	128	123.5	118.5	111.5	102	90	74.5	56.5	45.5
600FS14-3B-512250	250	340		171	151.5	143	139.5	135.5	130.5	124	116	104	90	73	63
600FS14-3A-512300	300	400	196	171	161.5	158	154.5	150	144.5	137.5	126.5	113	97	86.5	

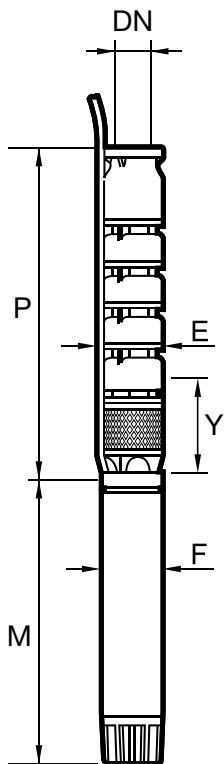

Model	stages	P	M	DN	E max	F	Y	Weight PEO (kg)	Order No
600FS14-1D-508075	1	1043	*	9"	340	190	6000	140	96514 600605
600FS14-1C-508093	1	1043	*	9"	340	190	6000	140	96514 600610
600FS14-1B-510110	1	1043	*	9"	340	237	6000	140	96514 600615
600FS14-1A-510130	1	1043	*	9"	340	237	6000	140	96514 600620
600FS14-2C-510150	2	1295	*	9"	340	237	6000	183	96514 600625
600FS14-2B-510170	2	1295	*	9"	340	237	6000	183	96514 600630
600FS14-2A-510185	2	1295	*	9"	340	237	6000	183	96514 600635
600FS14-3C-512220	3	1547	*	9"	340	286	6000	226	96514 600640
600FS14-3B-512250	3	1547	*	9"	340	286	6000	226	96514 600645
600FS14-3A-512300	3	1547	*	9"	340	286	6000	226	96514 600650

Notes:

1. Dimensions in millimetres
2. Refer to Franklin motor brochure for data
3. Minimum Well diameter is 14"
4. Pump supplied with counterflange, bolts, gasket
5. Minimum submergence is 6 metres (Y)

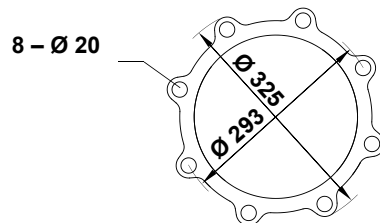

Outlet flange dimensions